

KLIPPO PARTS MANUAL

GARDEN PRO LINE

KLIPPO PRO E 400

GENERAL LIST

ITEM	PART NUMBER	DESCRIPTION	QUANTITY
1	MA 061 010 205	EXPLODED VIEW ASSEMBLY - LIST 1	1

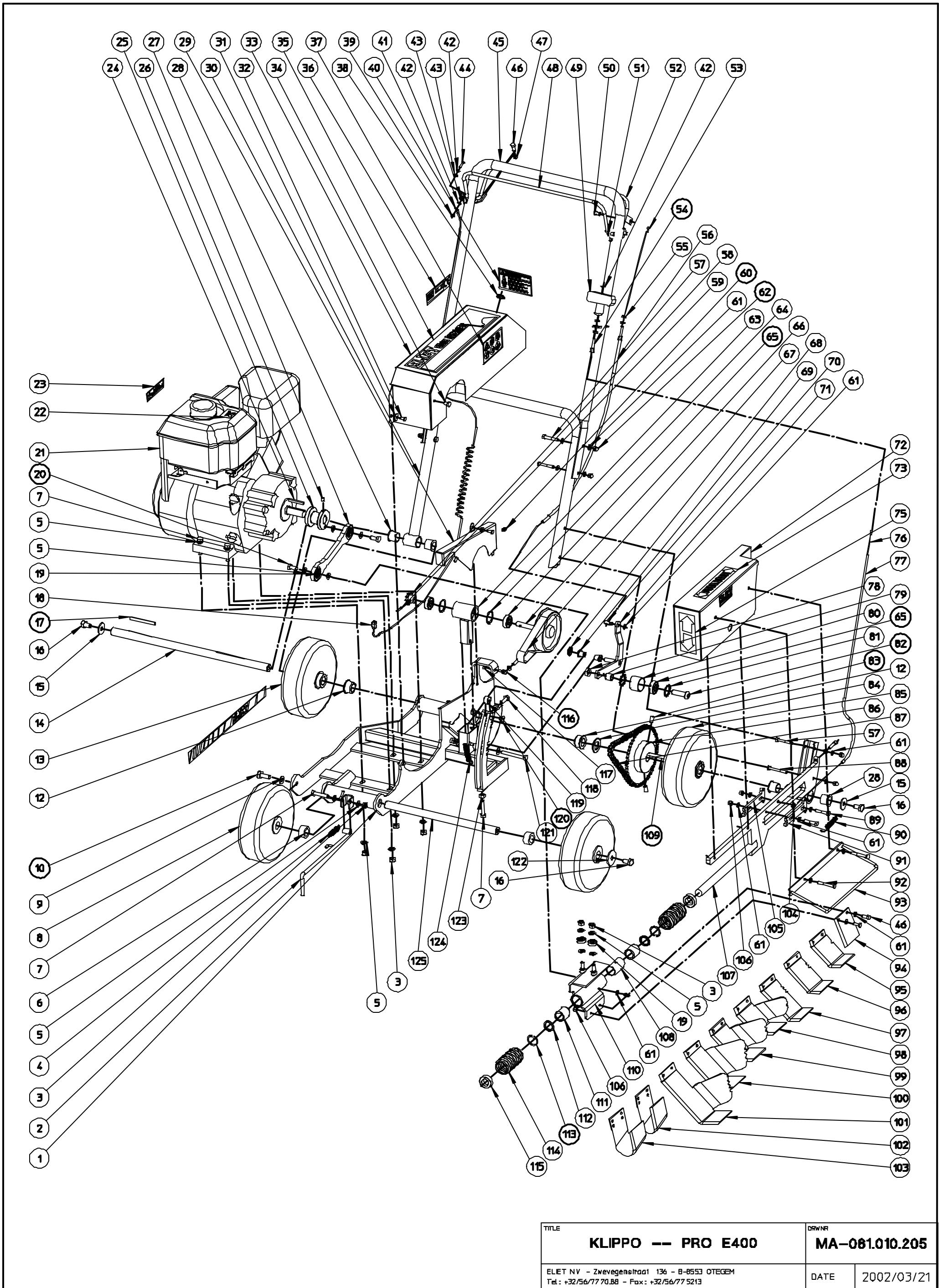

TITLE		DRAWNR	
KLIPPO -- PRO E400		MA-061.010.205	
ELET NV - Zwevegenstraat 136 - B-8553 OTEGEM Tel : +32/56/77 70.88 - Fax : +32/56/77 5213		DATE	2002/03/21

KLIPPO PRO E 400**ASSEMBLY LIST 1**

ITEM	PART NUMBER	DESCRIPTION	QUANTITY
1	64 MPA 01 120 010	FRAME	1
2	64 MPA 01 120 170	GUIDE	1
3	64 BS 502 000 800	NUT M8 DIN 985	8
4	64 BV 912 000 010	RETRACTING SPRING	1
5	64 BS 531 000 800	WASHER M8 DIN 125	20
6	64 BR 111 201 610	BUSHING Z 20,5/40x16	2
7	64 BS 512 000 840	BOLT M8X40 DIN 933	4
8	64 BW 320 020 120	WHEEL 200X60/65 (FRONT RIGHT)	2
9	64 BS 531 001 000	WASHER M10 DIN 125	1
10	64 BS 512 001 025	BOLT M10X25 DIN 933	1
12	64 BR 112 201 910	NYLON BEARING DIAM 35/30/20,5X2,5+16,5	2
13	64 BW 320 020 150	WHEEL WITHOUT SPROCKET 200X60/65 (BACK RIGHT)	1
14	64 MPA 01 120 220	REAR AXLE	1
15	64 BS 532 010 305	MUDWING REPAIR WASHER 30X10,5X2,5	2
16	64 BS 512 001 016	BOLT M10X16 DIN 933	3
17	64 BB 341 060 670	KEY 6X6X70 CF56	1
18	64 BE 031 034 201	BLUE WIRE CONNECTOR 2.5 MM	1
19	64 BL 000 802 203	BEARING TYPE EZO 608 ZZ	4
20	64 BS 012 000 818	BOLT M8X18 DIN 933	2
21	64 BM 212 104 000	ENBINE GX 120 HX4 red:1/6	1
22	64 BQ 505 010 060	STICKER HOT	1
23	64 BQ 505 010 020	STICKER MAX 2800 T/MIN 90X25MM	1

KLIPPO PARTS MANUAL**GARDEN PRO LINE****KLIPPO PRO E 400****ASSEMBLY LIST 1**

ITEM	PART NUMBER	DESCRIPTION	QUANTITY
24	64 BB 342 050 544	KEY 4,7x4,7x44	1
25	64 BA 506 050 195	ENGINE PULLEY D/50X3/4"X3/16"	1
26	64 BS 023 000 608	SET SCREW M6X8 DIN 916	1
27	64 MPA 01 120 160	ROD	1
28	64 BR 112 202 100	BUSHING DIAM. 29/24/20,4X1,1+20,4	4
29	64 MPA 01 120 140	CHAIN GUARD	1
30	64 MPA 01 120 420	UNDER BRACKET	1
31	64 BS 532 006 183	MUDWING REPAIR WASHER 18X6,5X1,5	2
32	64 BS 512 000 610	BOLT M6X10 DIN 933	3
33	64 MPA 01 120 430	GUARD (LARGE)	1
34	64 BR 602 006 151	RUBBER BUMPER K2581 TYPE 6	1
35	64 BQ 502 120 010	STICKER KLIPPO PRO E400 GARDEN PRO LINE	1
36	64 BQ 505 010 010	STICKER MOD/SERIE/MOTOR 125X30	1
37	64 BQ 505 010 050	STICKER WARNING GENERAL 100X60	1
39	64 BS 502 000 400	NUT M4 DIN 985	1
40	64 BQ 502 010 040	STICKER WARNING SPARKING PLUG 100X60	1
41	64 BE 090 131 721	WIRE CE 172 + M4 1,5 RED	1
42	64 BS 531 000 400	WASHER M4 DIN 125	3
43	64 BR 112 060 300	BUSHING 10/6/1 (10/5,9/4,2X1,7+1,3)	2
44	64 BS 512 000 416	BOLT M4X16 DIN 933	1
45	64 MPA 01 120 410	UPPER BRACKET	1
46	64 BS 512 000 616	BOLT M6X16 DIN 933	3
47	64 BS 501 000 600	NUT M6 DIN 934	1

KLIPPO PRO E 400

ASSEMBLY LIST 1

ITEM	PART NUMBER	DESCRIPTION	QUANTITY
48	64 MPA 01 120 060	STOP HANDLE	1
49	64 BN 230 200 100	GRIP LEVER 7/8"	1
50	64 BK 170 108 000	GROOVE NIPPLE MAG 8X15MM	1
51	64 BV 912 000 040	SPRING LEVER	1
52	64 MPA 01 120 050	DRIVE HANDLE	1
53	64 BK 151 200 970	FLEXIBLE STEEL WIRE 2MM N.5,8X11mm X 0,97	1
54	64 BK 610 100 600	CABLE SET SCREW M6x34 + NUT	4
55	64 BS 501 900 600	NUT M6 DIN 936 1/2	6
56	64 BK 212 060 570	CABLE CONDUCTOR	1
57	64 BS 511 000 640	BOLT M6X40 Din 931	5
58	64 BA 161 010 001	SPROCKET 10Z 3/8"X7/32" SIMPLEX	1
59	64 BB 120 040 200	SPRING PIN 4X20 DIN 1481	1
60	64 BY 100 106 100	GREACING NIPPLE M6	3
61	64 BS 531 000 600	WASHER M6 DIN 125	21
62	64 BS 505 500 600	NUT M6 DIN1587	6
63	64 MPA 01 120 070	SUPPORT DRIVE	1
64	64 BB 002 000 320	RETAINING RING FOR SHAFT DIAM32 DIN 472	2
65	64 BL 001 203 203	BEARING TYPE NTN 6201 ZZ	3
66	64 BA 536 103 120	PULLEY 114X103X90X28//23+2	1
67	64 BA 501 204 700	BELT 20X470MM	1
68	64 BB 011 000 100	STARLOCK DIAM 10MM	1
69	64 BR 112 101 500	BEARING 08/10 (18/13/10X2+13)	2
70	64 BK 170 208 000	CABLE FASTENER 8X15MM	1

KLIPPO PRO E 400**ASSEMBLY LIST 1**

ITEM	PART NUMBER	DESCRIPTION	QUANTITY
71	64 MPA 01 120 080	IDLER BRACKET	1
72	64 MPA 01 120 440	GUARD (SMALL)	1
73	64 BQ 502 120 020	STICKER HORIZONTAL ARROWS	1
75	64 BQ 502 120 030	STICKER UPWARD ARROWS	1
76	64 BK 151 200 900	FLEXIBLE STEEL WIRE 2MM N.5,8X11MM X 0,90	1
77	64 BK 212 060 600	CABLE CONDUCTOR	1
78	64 BS 501 901 200	NUT M12 DIN 936 1/2	1
79	64 MPA 01 120 240	SPACER	1
80	64 MPA 01 120 230	ROLLER	1
81	64 BB 021 000 320	SPRING CLIP DIAM 32MM	2
82	64 BS 522 501 240	SCREW M12X40 ISO 7380 10,9 IMBUS	1
83	64 BS 023 000 816	SET SCREW M8X16 DIN 916	2
84	64 BR 111 210 300	WASHER 37/21X3	1
85	64 BW 320 020 140	TRACTION WHEEL (BACK LEFT)	1
86	64 BA 161 050 201	SPROCKET 50T 3/8"X7/32" SIMPLEX	1
87	64 BA 101 068 010	ROLLER CHAIN 2191 3/8" SIMPLEX 68 LINKS	1
88	64 BS 511 000 642	BOLT M6X50 DIN 931	1
89	64 BS 511 000 635	BOLT M6X35 DIN 931	2
90	64 BV 912 000 030	RETRACTING SPRING FOR ADJUSTER ARM	1
91	64 MPA 01 120 100	ADJUSTER ARM	1
92	64 BS 511 000 641	BOLT M6X45 DIN 931	2
93	64 MPA 01 120 150	BLADE GUARD	1
94	64 BU 104 101 100	STRAIGHT BLADE	optional

KLIPPO PRO E 400

ASSEMBLY LIST 1

ITEM	PART NUMBER	DESCRIPTION	QUANTITY
95	64 BU 104 103 100	ANGULAR BLADE TYPE 1 V	optional
96	64 BU 104 103 200	ANGULAR BLADE TYPE 2 VV	optional
97	64 BU 104 103 300	ANGULAR BLADE TYPE 3 VVV	optional
98	64 BU 104 100 100	STANDARD BLADE TYPE 1 V	optional
99	64 BU 104 100 200	STANDARD BLADE TYPE 2 VV	optional
100	64 BU 104 100 300	STANDARD BLADE TYPE 3 VVV	optional
101	64 BU 104 100 400	STANDARD BLADE TYPE 4 VVVV	optional
102	64 BU 104 102 100	U-SHAPED BLADE 35MM	optional
103	64 BU 104 102 200	U-SHAPED BLADE 50MM	optional
104	64 BK 170 207 000	CABLE FASTENER 7X10MM	1
105	64 MPA 01 120 110	ADJUSTER ARM	1
106	64 BS 502 000 600	NUT M6 DIN 985	4
107	64 MPA 01 120 020	BLADE ARM	1
108	64 MPA 01 120 250	CONNECTING PIECE BLADE BRACKET	1
109	64 BB 341 060 680	KEY 6X6X80 CF56	1
110	64 MPA 01 120 090	BLADE BRACKET	1
111	64 BL 866 010 010	BUSH BEARING	2
112	64 BR 302 120 284	SEALING	2
113	64 BB 002 000 280	RETAINING RING FOR SHAFT DIAM 28 DIN 472	2
114	64 BR 000 811 930	DUST PROTECTION	2
115	64 BR 111 201 010	RING ERTALON	2
116	64 BK 610 200 500	CABLE FASTENER	1
117	64 BS 501 000 500	NUT M5 DIN 934	1

KLIPPO PARTS MANUAL**GARDEN PRO LINE****KLIPPO PRO E 400****ASSEMBLY LIST 1**

ITEM	PART NUMBER	DESCRIPTION	QUANTITY
118	64 BS 512 000 825	BOLT M8X25 DIN 933	1
119	64 MPA 01 120 200	BUSHING	1
120	64 BS 522 100 810	SET SCREW M8X10 DIN 7991 IMBUS	2
121	64 BS 512 000 845	BOLT M8X65 DIN 933	1
122	64 BS 532 010 406	MUDWING REPAIR WASHER 40X10,5X3	1
123	64 BS 501 000 800	NUT M8 DIN 934	2
124	64 BV 912 000 020	SPRING IDLER RETURN	1
125	64 MPA 01 120 210	FRONT AXLE	1

MA 061 010 205

Last modified: 2002/03/21